

# Tommy Stainless Steel LED Light Tree Stand

Part Number: E-LT

Description:

Price: \$

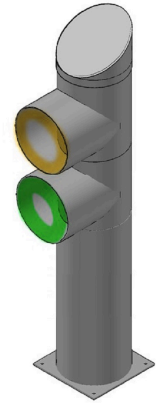

## Detailed Description

Enhance your car wash site with our versatile Tommy Light Tree stands, perfect for multiple locations including the point-of-sale area next to the gate arm and the end of the wash tunnel. Available in either a two-light or three-light design, these light trees come in 24V or 100V LED options with color choices of Red, Yellow, or Green. You can also select from a variety of decal styles for each light or opt for no decals.

Constructed from stainless steel to withstand outdoor elements, the tree light frame features a 12-3/8" outside diameter and stands 68" tall, extending 18" deep from the back of the frame to the front of the canister. The light canisters themselves are 12-3/8" in diameter with a 7-1/2" square opening for mounting. The base has a square 13-3/4" diameter with a 4" center cut hole for wiring and four 5/8" mounting holes.

## Specifications

- # of Light Options: 2 or 3
- Light Diameter: 12"
- Light Voltage Options: 24V or 110V
- Light Operating Temp. Range: -40F-165F
- Light Color Options: Red, Yellow, or Green
- Light Decals: Variety
- Light Tree Height: 68" Tall
- Light Tree Frame Diameter: 12-3/8"
- Base Plate Diameter: 13-3/4" Square
- Base Plate Center Hole Diameter: 4"
- Base Plate Mounting Hole Diameter: 5/8"
- Light Tree Material: Stainless Steel
- Grade: 304